

SUMMARY



Image is for illustrative purpose only

Wires

| | |
|---------|---|
| Low | 6 |
| High | 0 |
| Coax | 0 |
| Triax | 0 |
| Quad | 0 |
| Fiber | 0 |
| Fluidic | 0 |

Download

[Request a quote](#)

[Catalog](#)

| | |
|------------------|------------------------|
| Series | 1B |
| Termination type | Coupler/adaptor/bridge |
| IP rating | 50 |
| Cable Ø | 0.00 - 0.00 mm |
| Status | active |
| Alternative part | |

TECHNICAL DETAILS

Mechanics

| | |
|-------------------|--|
| Shell Style/Model | RG*: Fixed coupler, nut fixing, key (G) at the flange end and keys (G,J or M) at the other end |
| Keying | Front side: 1 key (alpha=0, female) ; Other side: 2 keys (gamma=45, male) |
| Housing Material | Brass (chrome plated) shell and collet nut, nickel plated brass latch sleeve and mid pieces |
| Variant | |
| Weight | 27.31 g |

Performance

| | |
|---------------|---------------------------|
| Configuration | 1B.306 : 6 Low Voltage |
| Insulator | L: PEEK (UL 94 / V-0/1.5) |
| Rated Current | 7 Amps |

Specifications

| | |
|--------------------------|--------------------------|
| Contact Type: | Solder |
| Contact Dia.: | 0.7 mm (0.03in) |
| Vtest (contact-shell): | 1200 V (AC), 1700 V (DC) |
| Vtest (contact-contact): | 1050 V (AC), 1490 V (DC) |

LEMO products and services are provided "as is". LEMO makes no warranties or representations with regard to LEMO product & services or use of them, express, implied or statutory, including for accuracy, completeness, or security. The user is fully responsible for his products and applications using LEMO components.

Others

Endurance (Shell): 5000
Temp (min / max): -55°C / +250°C
Humidity (max): <=95% [at 60 deg C /140 F]
Vibration: 15 g [10 Hz - 2000 Hz]
Shock Resistance: 100 g [6 ms]
Climatical Category: 50/175/21
Shielding (min): 75 dB (10 MHz)
Shielding (min): 40 dB (1 GHz)
Salt Spray Corrosion: >1000 hr
IP Rating: 50

DRAWINGS

Draws

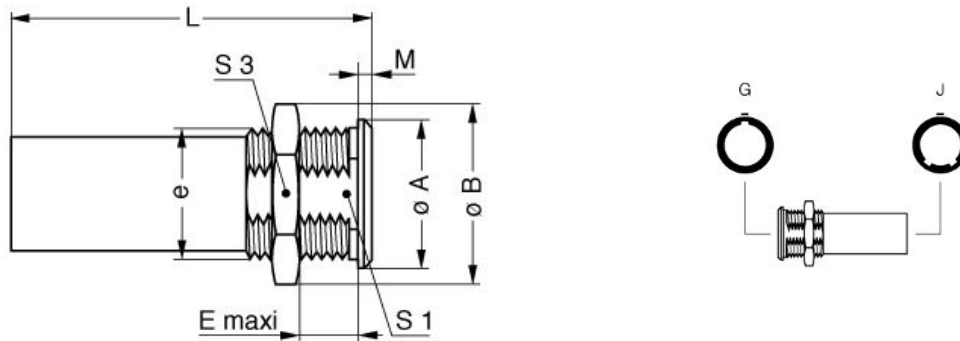

Dimensions

| | A | B | E | Lmax | M | S1 | S3 | e |
|-----|------|------|------|------|------|------|------|----------|
| mm. | 16 | 19.5 | 8.5 | 47 | 2.5 | 12.5 | 17 | M14x1.00 |
| in. | 0.63 | 0.77 | 0.33 | 1.85 | 0.10 | 0.49 | 0.67 | |

RECOMMENDED BY LEMO

Tools

None

LEMO products and services are provided "as is". LEMO makes no warranties or representations with regard to LEMO product & services or use of them, express, implied or statutory, including for accuracy, completeness, or security. The user is fully responsible for his products and applications using LEMO components.

Cables

LEMO products and services are provided "as is". LEMO makes no warranties or representations with regard to LEMO product & services or use of them, express, implied or statutory, including for accuracy, completeness, or security. The user is fully responsible for his products and applications using LEMO components.